

MIL. SPEC SWAGE FORK

STAINLESS STEEL

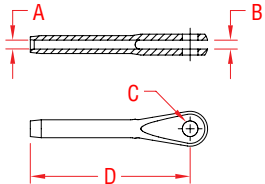

ITEM	A	B	C	D	BEFORE	AFTER	WT
	(wire)				(swage)	(swage)	(lb)
MS20667-2	1/16"	0.09"	0.19"	1.57"	0.160"	0.138"	0.01
MS20667-3	3/32"	0.11"	0.19"	1.95"	0.218"	0.190"	0.02
MS20667-4	1/8"	0.20"	0.19"	2.35"	0.250"	0.219"	0.03
MS20667-5	5/32"	0.20"	0.25"	2.67"	0.297"	0.250"	0.04
MS20667-6	3/16"	0.26"	0.31"	3.07"	0.359"	0.313"	0.09
MS20667-8	1/4"	0.31"	0.38"	3.81"	0.494"	0.438"	0.21
MS20667-10	5/16"	0.35"	0.44"	4.44"	0.635"	0.563"	0.40
MS20667-12	3/8"	0.38"	0.50"	5.33"	0.703"	0.625"	0.58

NOTE: THESE FITTINGS MEET MIL SPEC #MS20667 AND HAVE MET ALL QUALITY AND TESTING REQUIREMENTS PER MIL-DTL-781 AND ARE APPROVED FOR LISTING IN QPL-781. MACHINE SWAGE ONLY.

MIL.SPEC