

TURNBUCKLE EYE

UNC THREAD - 316 STAINLESS STEEL

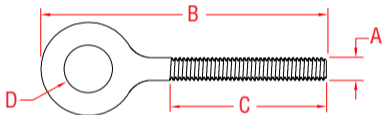

ITEM	A	B	C	D	WLL	WT
	(size)				(lb)	(lb)
RIGHT HAND, UNC						
P0154-RE05	3/16"	2.75"	1.73"	0.38"	300	0.02
P0154-RE07	1/4"	3.15"	2.06"	0.44"	440	0.04
P0154-RE08	5/16"	3.76"	2.53"	0.52"	800	0.08
P0154-RE10	3/8"	5.48"	3.78"	0.67"	1,200	0.18
P0154-RE13	1/2"	5.87"	3.79"	0.78"	2,200	0.35
P0154-RE16	5/8"	7.84"	5.35"	0.87"	2,800	0.73
P0154-RE20	3/4"	9.16"	6.28"	1.15"	3,500	1.30
LEFT HAND, UNC						
P0154-LE05	3/16"	2.75"	1.73"	0.38"	300	0.02
P0154-LE07	1/4"	3.15"	2.06"	0.44"	440	0.04
P0154-LE08	5/16"	3.76"	2.53"	0.52"	800	0.08
P0154-LE10	3/8"	5.48"	3.78"	0.67"	1,200	0.18
P0154-LE13	1/2"	5.87"	3.79"	0.78"	2,200	0.35
P0154-LE16	5/8"	7.84"	5.35"	0.87"	2,800	0.73
P0154-LE20	3/4"	9.16"	6.28"	1.15"	3,500	1.30

NOTE:
USE WITH "OPEN" TURNBUCKLE BODY (P0105-BD, PAGE 23).