



SUNCOR STAINLESS, INC. [Contact Information](#)

Customer Service

(800) 394-2222
(508) 732-9191

Facsimile

(508) 732-9798

Web Address

www.suncorstainless.com

Mailing Address

Suncor Stainless, Inc.
70 Armstrong Rd.
Plymouth, MA 02360

Rivet Nut Installation Tool (S0380-0000) Instructions

Rivet Nut Installation Tool Kit Components

- Rivet Nut Installation Tool
- Wrench
- Mandrel – 1/4"-28 RH
- Mandrel – 1/4"-28 LH
- Mandrel – 3/16" 10-24 RH
- Mandrel – 1/4"-20 RH
- Mandrel – 5/16"-18 RH
- Mandrel – 3/8"-16 RH
- Mandrel – 1/4"-20 LH
- Mandrel – M3 x .5
- Mandrel – M4 x .7
- Mandrel – M5 x .8
- Mandrel – M6 x 1.0
- Mandrel – M8 x 1.25
- Mandrel – M10 x 1.5
- Mandrel – M12 x 1.75

Rivet Nut Installation Tool Features

1. Installation Knob
2. Mandrel Stem
3. Outer & Inner Sheath
4. Locking Nut
5. Scale Identification



6. Mandrel Nozzle

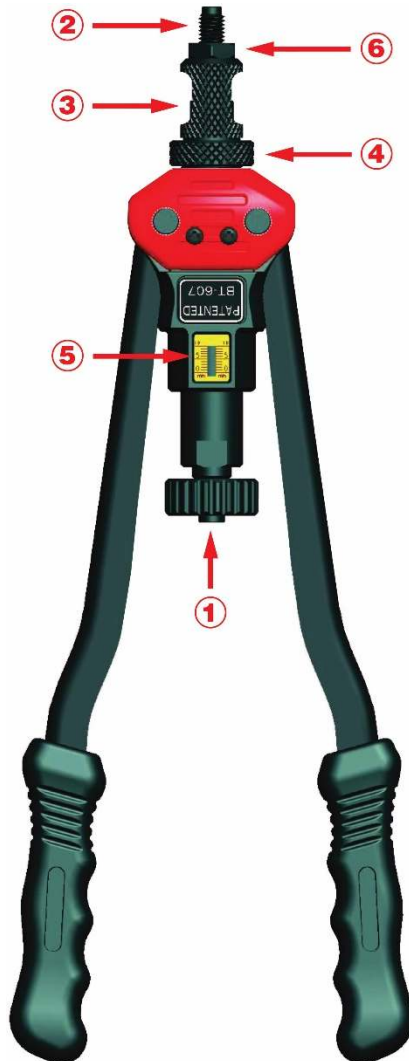

Table of Contents

Rivet Nut Installation Tool Kit Components	1
Rivet Nut Installation Tool Features	1
Installation Steps	2
Changing the Mandrel	2
Manual Release of the Rivet Nut Installation Tool	2



Figure A. Open the handles to thread the rivet nut onto the mandrel stem.

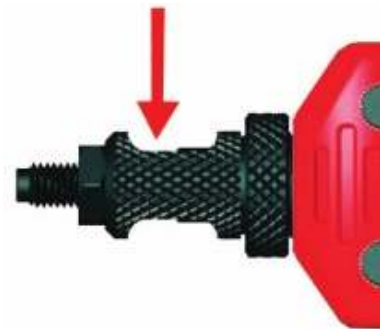

Figure B. Rotating the outer sheath outward or inward will cause the working stroke to become longer or shorter respectively.

Installation Steps

This rivet nut installation tool features a scale identification so the working stroke can easily be known.

Open the handles to thread the rivet nut onto the mandrel stem (Figure A). By rotating the outer sheath outwards, the working stroke will become longer. Rotating the outer sheath inwards will cause the working stroke to become shorter (Figure B). Once the appropriate working stroke has been established, tighten the locking nut. Using the wrench (included), tighten the mandrel nozzle (Figure C).

With the rivet nut fully threaded on the mandrel stem, put the rivet nut into the hole and close the handles to rivet (Figure D).

NOTE: FOR OPTIMAL RESULTS, MAKE SURE THE RIVET NUT IS FULLY INSERTED AGAINST THE SHOULDER.

Rotate the installation knob counterclockwise to release the rivet nut installation tool after riveting (Figure E).

NOTE: FOR LEFT HAND THREAD RIVET NUTS, RELEASE THE RIVET NUT INSTALLATION TOOL BY TURNING THE INSTALLATION KNOB CLOCKWISE.

Changing Mandrels

Use the supplied wrench to remove the mandrel nozzle (Figure C). Push the inner sheath back and hold it down. Rotate the mandrel to remove it (Figure F).

To attach a mandrel, push the inner sheath back and screw in the mandrel. Thread on and tighten the mandrel nozzle (Figure G). Release the inner sheath.

Manual Release of the Rivet Nut Installation Tool

During the riveting process, if the rivet nut installation tool cannot be removed, do not try to remove it forcefully. Insert an Allen wrench (6mm) into the hole on the shaft of the mandrel and rotate to remove the rivet nut installation tool (Figure H).

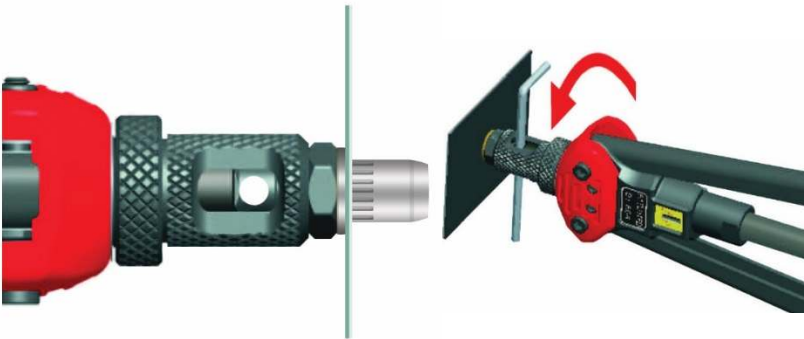

Figure H. Insert an Allen wrench into the hole on the shaft of the mandrel and rotate to release the rivet nut installation tool.



Figure C. Use the supplied wrench to tighten or remove the mandrel nozzle.

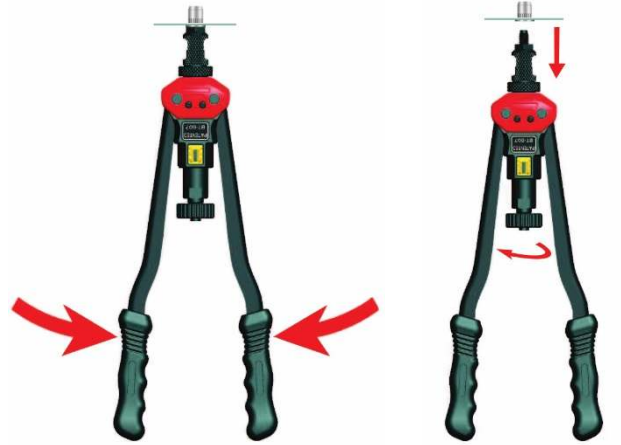

Figure D. (Left) Put the rivet nut into the hole and close the handles to rivet.

Figure E. (Right) Rotate the installation knob to exit the rivet nut installation tool.



Figure F. To release mandrel, push the inner sheath back and unscrew the mandrel.



Figure G. Push the inner sheath back and screw in the mandrel. Thread on and tighten the mandrel nozzle.