

# HEAVY DUTY WIDE STRAP HINGE

**316 STAINLESS STEEL**

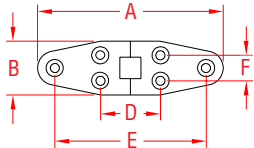
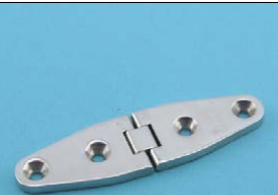

**ITEM**

**A**

**B**

**C**

**D**

**E**

**F**

**WT**

(length)

(lb)

**HEAVY DUTY**

S3832-0001

4"

1.11"

0.19"

1.40"

3.40"

N/A

0.18

S3832-0002

6"

1.63"

0.23"

2.07"

4.85"

0.83"

0.46

**NOTE:**

**USE 4 OR 6 #10 FASTENERS.**

**EXCLUSIVE FLUSH DESIGN CAN MOVE 360 DEGREES. ONE HALF FOLDS FLAT ON TOP OF OTHER HALF. IDEAL FOR TABLES, DOORS AND OTHER APPLICATIONS WHERE RECESSED HINGES ALLOW A TOTALLY FLAT SURFACE.**

**REFERENCE "FASTENER MATCHING CHART" (PAGE 159) FOR COMPATIBLE FASTENERS.**